

PIANTA CABINA

(A)

<p>Modulo Climac srl Via GANDHI 9 29030 ERBUSCO (BS) TEL./FAX 030 7709280</p>		<p>OGGETTO: CABINA ELETTRICA PREFABBRICATA MONOBLOCCO DG2061 Rev.07.1</p>		<p>TAVOLA: 1 DI 7</p>	
<p>COMMITTENTE:</p>		<p>DATA EMISSIONE:</p>		<p>CATEGORIA SISMICA: <input type="radio"/> I <input type="radio"/> II <input type="radio"/> III <input type="radio"/> IV <input type="radio"/> V</p>	
<p>CANTIERE:</p>		<p>FINITURA ESTERNA: LISCIA FONDO CASSERO</p>		<p>SOVR. IN COPERTURA: 400 Kg/Mq (ACO+FERM)</p>	
<p>MISURE INTERNE: 230x553 H=230</p>		<p>NOTE:</p>		<p>FILE:</p>	
<p>ISIMO Via S. Maria 10 29030 ERBUSCO (BS) Tel. 030 7709280</p>		<p>DG2061 - Rev.07.1</p>		<p>DISEGNATORE:</p>	

GUAINA BITUMINOSA
SP. 4 MM. +ARDESIA

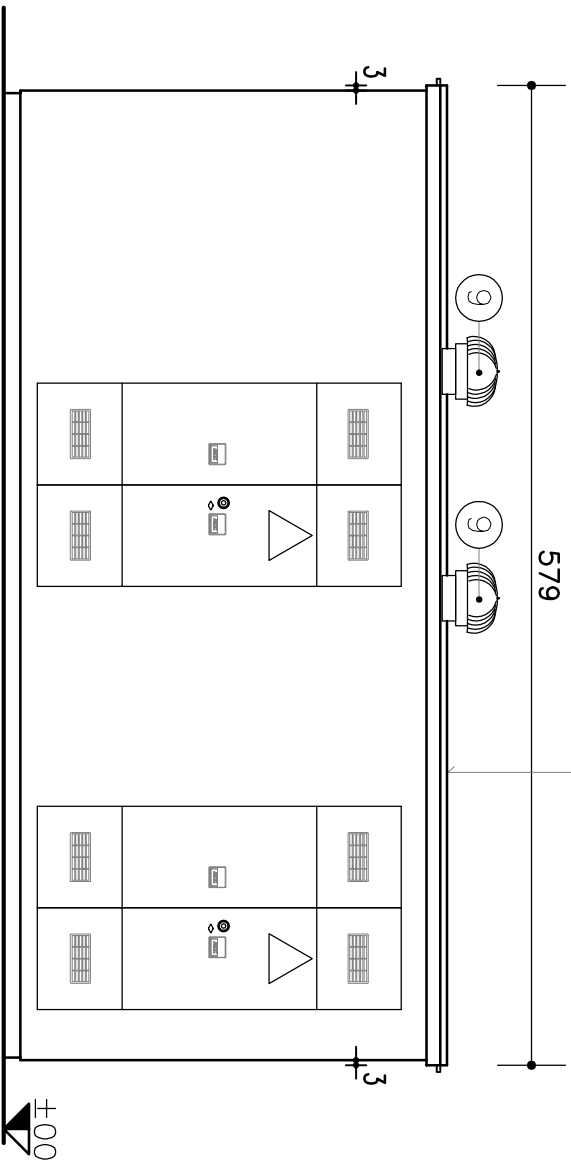

PROSPETTO A

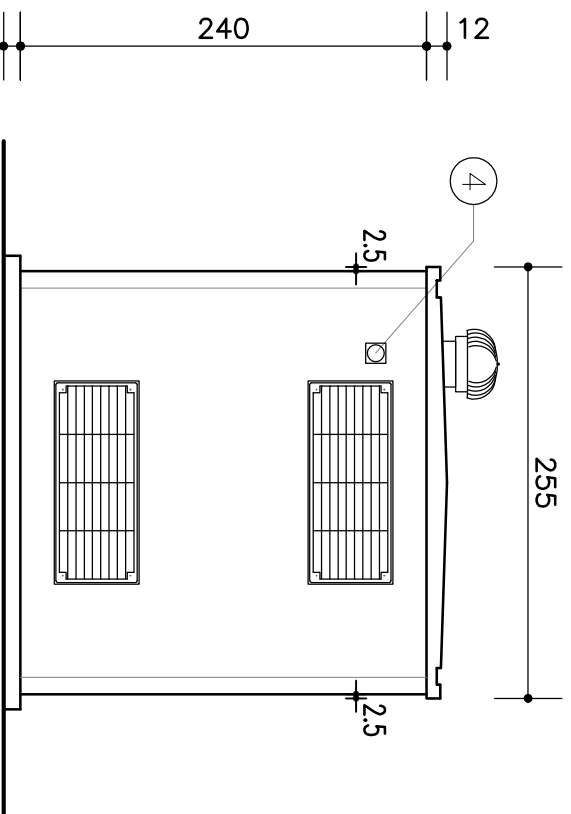

PROSPETTO B



Modulo Cimac srl

Via Gandhi 9

29030 ERBUSCO (BS)

TEL./FAX 030 7709280



OGGETTO: **CABINA ELETTRICA PREFABBRICATA MONOBLOCCO DG2061 Rev.07.1**

COMMITTENTE:

CANTIERE:

MISURE INTERNE: **230x553 H=230**

FINITURA ESTERNA: **LISCIA FONDO CASSERO**

NOTE:

TAVOLA: **3 DI 7**

DATA EMISSIONE:

CATEGORIA SISMG: **I O II O III O IV O**

SOVR. IN COPERTURA: **400 Kg/Mq (ACO+FERM)**

FILE:

DISEGNATORE:

DG2061 - Rev.07.1

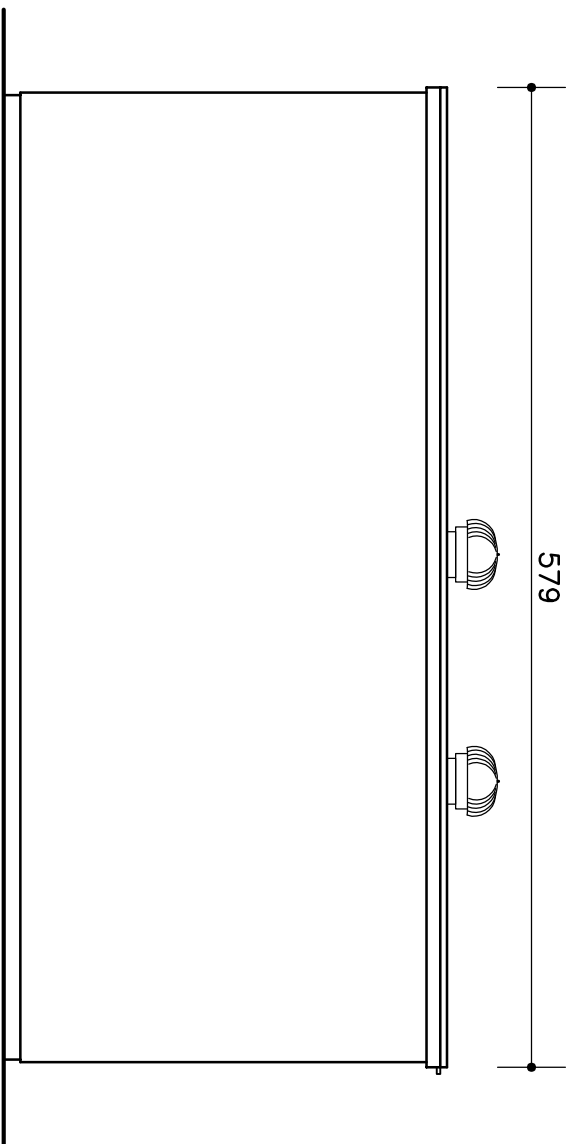

PROSPETTO C

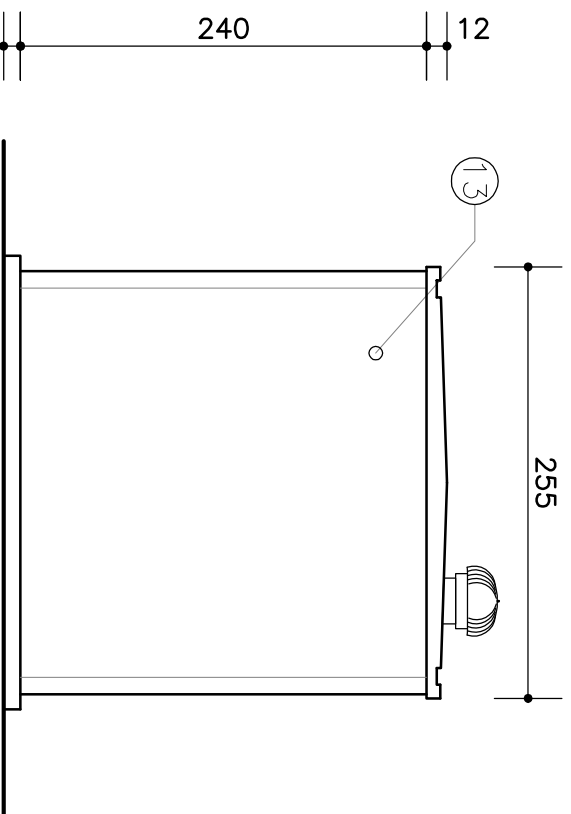

PROSPETTO D



Modulo Cimatec srl

Via Gandhi 9

29030 ERBUSCO (BS)

TEL/FAX 030 7709280



19010

OGGETTO: **CABINA ELETTRICA PREFABBRICATA MONOBLOCCO DG2061 Rev.07.1** TAVOLA: **4 DI 7**

COMMITTENTE: _____ DATA EMISSIONE: _____

CANTIERE: _____ CATEGORIA SISMICA: **I O II O III O IV O**

MISURE INTERNE: **230x553 H=230** FINITURA ESTERNA: **LISCIA FONDO CASSERO** SOVR. IN COPERTURA: _____

NOTE: _____ FILE: **400 Kg/Mq** (ACO+PERM)

DISEGNATORE: _____

DG2061 - Rev.07.1

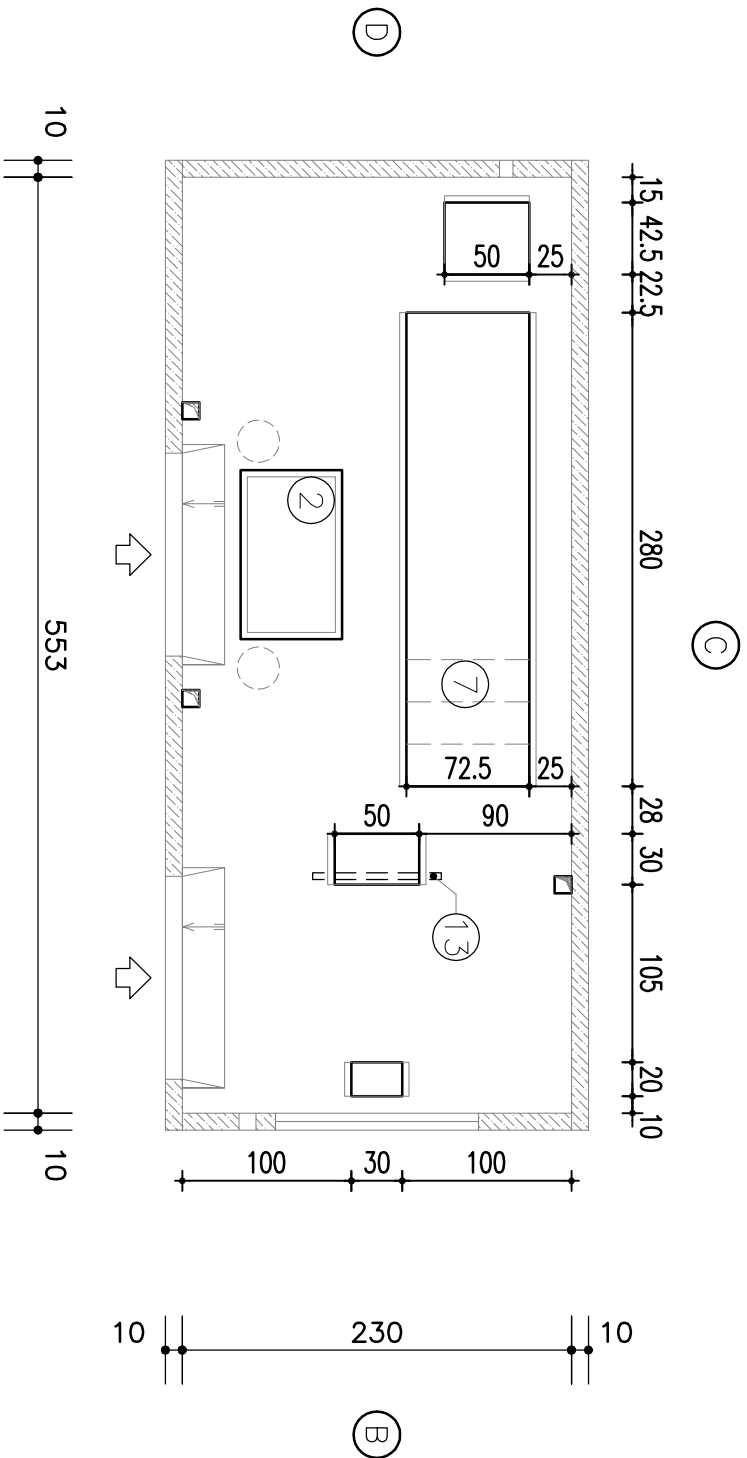

PIANTA PAVIMENTO

(A)

<p>Modulo Cimac srl Via Gandhi 9 29030 ERBUSCO (BS) TEL./FAX 030 7709280</p> <p>ISMO Incarichi 90/90 SISTEMI PER CANTIERE N. 94113</p>		<p>OGGETTO: CABINA ELETTRICA PREFABBRICATA MONOBLOCCO DG2061 Rev.07.1</p> <p>COMMITTENTE:</p> <p>CANTIERE:</p> <p>MISURE INTERNE: 230x553 H=230</p> <p>NOTE:</p>		<p>TAVOLA: 5 DI 7</p> <p>DATA EMISSIONE:</p> <p>CATEGORIA SISMICA: I O II III IV</p> <p>SOVR. IN COPERTURA: 400 Kg/Mq (ACO+FERM)</p> <p>FILE:</p> <p>DISEGNATORE:</p>	
<p>FINITURA ESTERNA: LISCIA FONDO CASSERO</p>		<p>FINITURA INTERNA: LISCIA FONDO CASSERO</p>		<p>FILE:</p>	

DG2061 - Rev.07.1

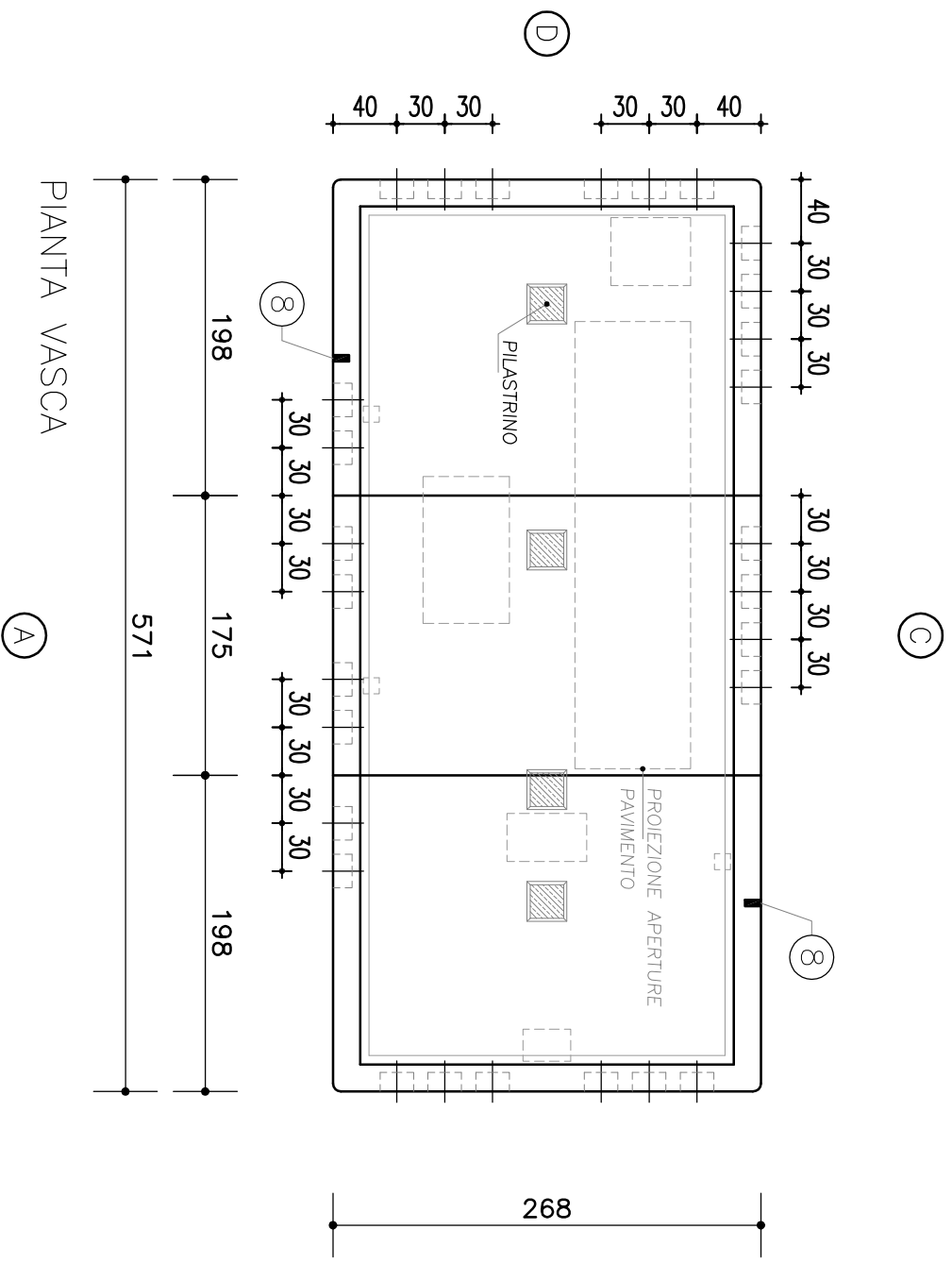

PIANTA VASCA

 Gruppo Siderurgico
 Centro Adriatico
 SIDERURGIA
 SIDERURGIA
 SIDERURGIA

Modulo Cimac srl
 Via Gandhi 9
 29030 ERBUSCO (BS)
 TEL./FAX 030 7709280

 ICMO
 Modulo 90 900

OGGETTO:	CABINA ELETTRICA PREFABBRICATA MONOBLOCCO DG2061 Rev.07.1		TAVOLA:	6 DI 7
COMMITTENTE:	---		DATA EMISSIONE:	---
CANTIERE:	---		CATEGORIA SISMICA:	I <input type="checkbox"/> II <input type="checkbox"/> III <input type="checkbox"/> IV <input type="checkbox"/>
MISURE INTERNE:	230x553 H=230	FINITURA ESTERNA:	SOVR. IN COPERTURA:	<input type="checkbox"/>
NOTE:	LISCIA FONDO CASSERO		FILE:	400 Kg/Mq (ACO+FERM)
			DISEGNATORE:	---

DG2061 - Rev.07.1

SCHEMA ESPLICATIVO SCAVO E PLATEA DI FONDAZIONE PER CABINA A PANNELLI CON VASCA PREFABBRICATA

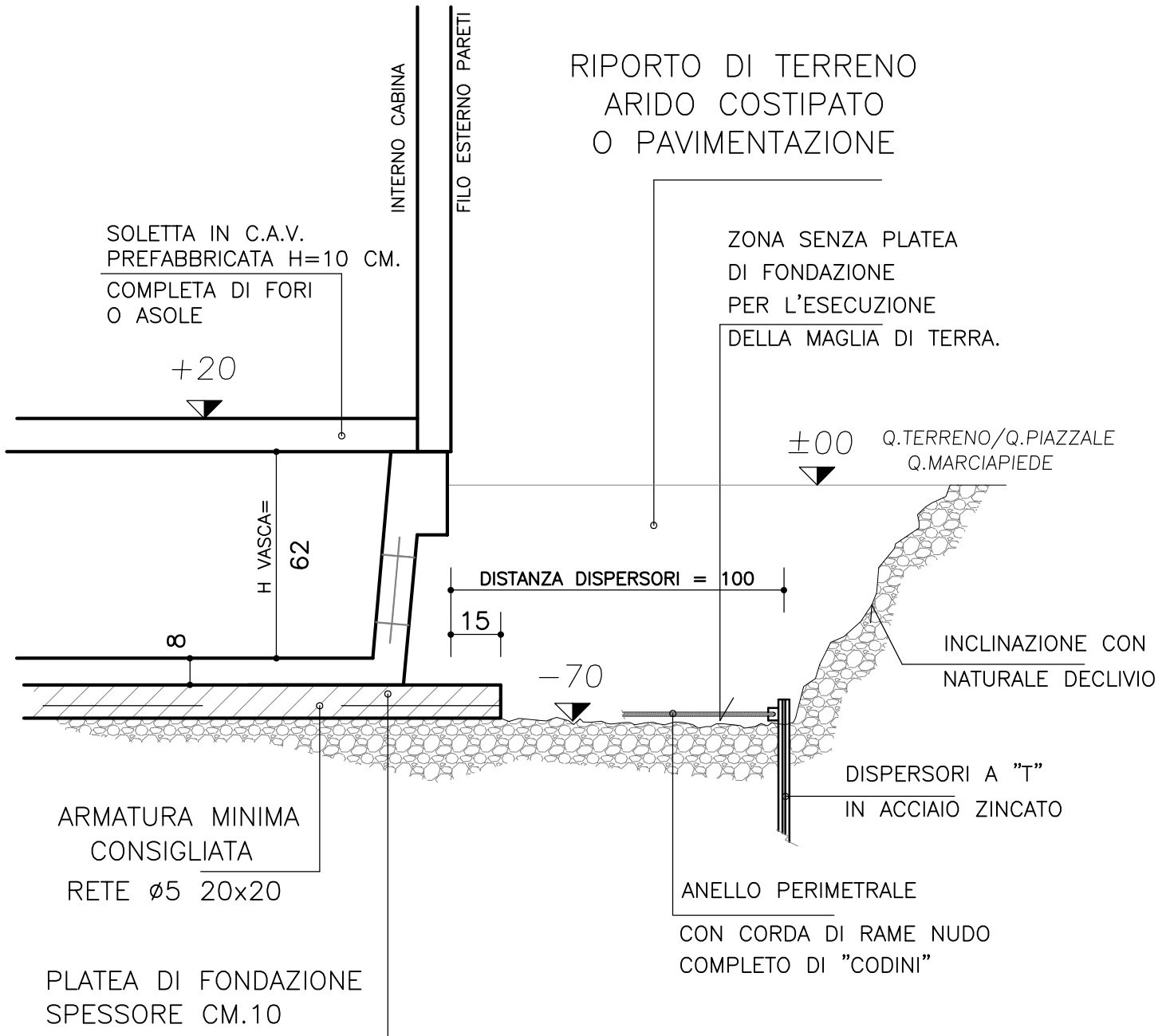

 Modulo Cimac srl Via GANDHI,9 25030 ERBUSCO (BS) TEL./FAX 030 7709280  ICMQ NORMA ISO 9001 CERTIFICAZIONE SISTEMA QUALITA' CERT. N. 96112	OGGETTO:	CABINA ELETTRICA PREFABBRICATA MONOBLOCCO DG2061 Rev.07.1	TAVOLA:	7 DI 7		
	COMMITTENTE:	---	DATA EMISSIONE:	---		
	CANTIERE:	---	CATEGORIA SISMICA:	I <input type="radio"/> II <input type="radio"/> III <input type="radio"/> IV <input type="radio"/>		
	MISURE INTERNE:	230x553 H=230	FINITURA ESTERNA:	LISCIA FONDO CASSERO	SOVR. IN COPERTURA:	400 KG/MQ. (ACC+PERM)
	NOTE:	DG2061 - Rev.07.1			FILE:	---
			DISEGNATORE:	---		

TAVOLA PARTICOLARI PER CABINA ELETTRICA

①

RIALZO PER TENUTA OLIO

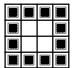
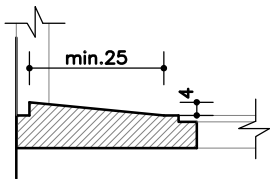

②

COPERTURA PASSO UOMO ACCESSO VASCA

N.1 VETRORESINA
SUP. ANTIDRUCCIOLO
SPESSORE 4,1 CM.

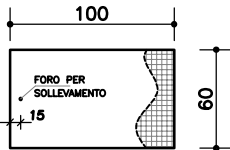

④

PASSANTE PER CAVI
TEMPORANEO Ø80mm



⑤

QUADRO ELETTRICO
DY3016/1



⑥

N.3 LAMPADE DI ILLUMINAZIONE
c/PLAFONIERA STAGNA DY3021

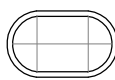

⑦

N.3 ELEMENTI DI COPERTURA
IN VETRORESINA
80x25 SPESSORE 4 CM.

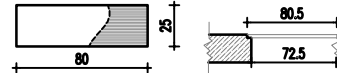

⑧

CONNETTORE INTERNO/ESTERNO
RETE DI TERRA

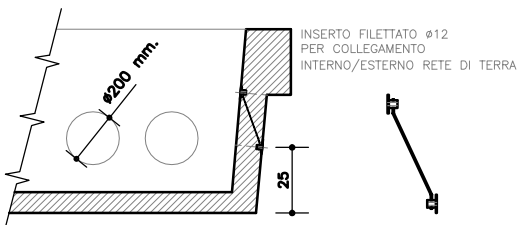

⑨

ASPIRATORE EOLICO
IN ACCIAIO INOX Ø25cm

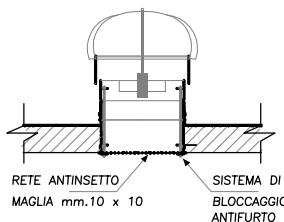

⑩

CANALETTA in VTR
USCITA ACQUA PIOVANA

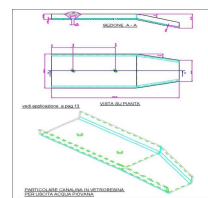

⑪

FLANGIA A FRATTURA IN POLIETILENE
AD ALTA DENSITA'

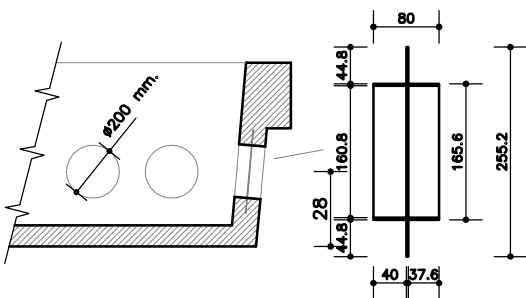

⑪A

N.7 PASSANTI STAGNI
(n°2 per CAVI MT, n°4 per CAVI BT
+ n°1 CAVI RACK)

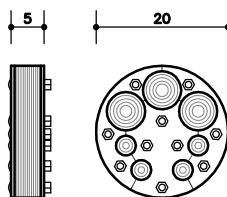

⑫

SISTEMA PASSACAVI
PER CAVI ANTENNA RACK

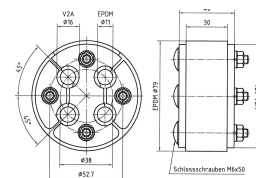

⑬

TELAIO PORTA
QUADRI BT

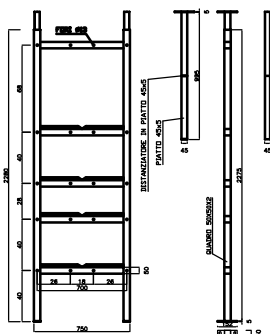

RETE DI TERRA INTERNA

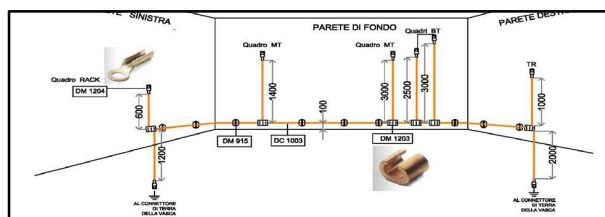

Modulo Cimac srl
Via GANDHI,9
25030 ERBUSCO (BS)
TEL./FAX 030 7709280



OGGETTO: CABINA ELETTRICA PREFABBRICATA MONOBLOCCO DG2061 Rev.07.1		TAVOLA: 1 DI 1
COMMITTENTE: ---		DATA EMISSIONE: ---
CANTIERE: ---		CATEGORIA SISMICA: I ○ II ○ III ○ IV ○
MISURE INTERNE: 230x553 H=230	FINITURA ESTERNA: LISCIA FONDO CASSERO	SOVR. IN COPERTURA : 400 KG/MQ. (ACC+PERM)
NOTE: DG2061 - Rev.07.1		FILE: ---
		DISEGNATORE: ---